

DATE PLOTTED: 20 January 2017 11:09 AM BY: NATHAN WHITE

XREFS: XR-CG150059-CI-BASE: XR-CG150059-CI-FUTURE: XR-CG150059-CI-CH-FUTURE: XR-CG150059-CI-SURVEY: XR-CG150059-CI-TITLEBLOCK: XR-CG150059-CI-SERTABLE: XR-CG150071-CI-BASE
CAD File: O:\DRAC\12015\CG150059 - Wynbrook Estate Stage 2\CG150059-CI-1100.dwg

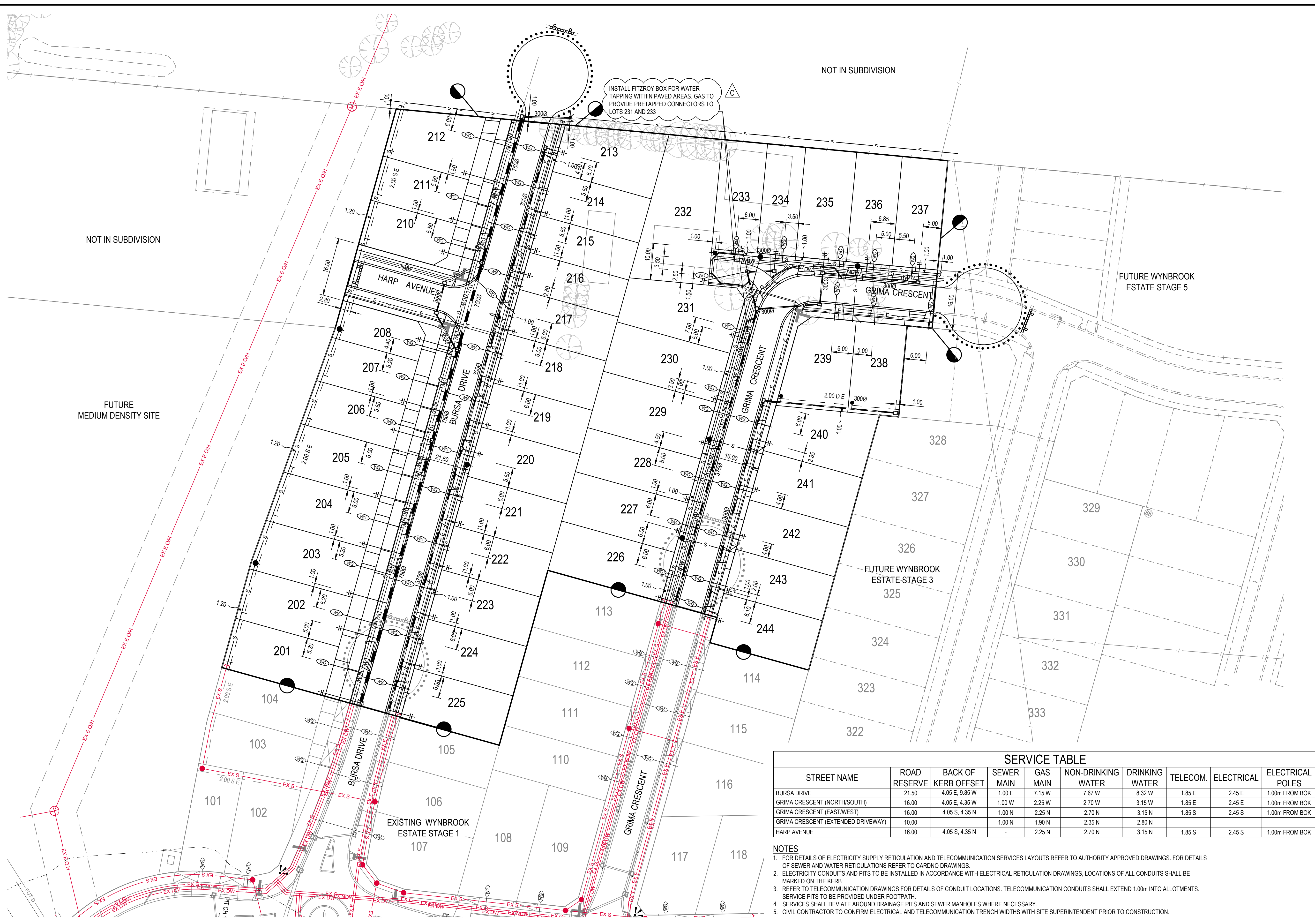

LEGEND

- CENTRELINE OF ROAD
- KERBS AND CHANNEL (AS SHOWN)
- PROPOSED RETAINING WALL
- PROPOSED ZERO LOT LINE
- STAGE BOUNDARY
- EXISTING TREE
- ⊗ EXISTING TREE TO BE REMOVED
- ⊗ EXISTING FEATURES TO BE REMOVED
- DIRECTIONAL HAZARD
- TACTILE GROUND SURFACE INDICATORS
- LIMIT OF WORKS
- "NO ROAD" SIGN AND BARRIER
- PROPOSED TRAFFIC SIGN
- PROPOSED STREET SIGN
- LINEMARKING AND RRPM'S
- PROPOSED STORMWATER DRAIN, PIT, DIAMETER AND PROPERTY INLET
- PROPOSED MAIN DRAIN, PIT AND DIAMETER
- EXISTING STORMWATER DRAIN, PIT, DIAMETER AND PROPERTY INLET
- EX-D --- EXISTING DRAINAGE
- PROPOSED SWALE DRAIN
- OFFSET FROM BUILDING LINE
- PROPOSED SEWER, MAINTENANCE STRUCTURES AND PROPERTY BRANCH
- EX-S --- EXISTING SEWER, MAINT. STRUCTURES
- W --- PROPOSED WATER
- G --- PROPOSED GAS
- E --- PROPOSED ELECTRICITY
- T --- PROPOSED TELECOMMUNICATION
- RM --- PROPOSED RISING MAIN
- DW --- PROPOSED DRINKING WATER
- NDW --- PROPOSED NON-DRINKING WATER
- LIGHT POLES, 50 m INTERVAL
- CONDUIT: WATER 100mm Ø CLASS 12 UPVC
GAS 50mm Ø CLASS 12 UPVC
UNLESS SHOWN OTHERWISE
- IR --- IRRIGATION CONDUIT
- EX-W --- EXISTING WATER
- EX-G --- EXISTING GAS
- EX-E --- EXISTING ELECTRICITY
- EX-T --- EXISTING TELECOMMUNICATION
- EX-RM --- EXISTING RISING MAIN
- EX-DW --- EXISTING DRINKING WATER
- EX-NDW --- EXISTING NON-DRINKING WATER
- EX-WG --- EXISTING WATER AND GAS CONDUIT
- IR --- EXISTING IRRIGATION CONDUIT

WARNING
HIGH PRESSURE GAS MAINS IN CLOSE PROXIMITY

WARNING
BEWARE OF UNDERGROUND SERVICES
THE LOCATION OF UNDERGROUND SERVICES ARE APPROXIMATE ONLY AND THEIR EXACT POSITION SHOULD BE PROVEN ON SITE. NO GUARANTEE IS GIVEN THAT ALL EXISTING SERVICES ARE SHOWN.

STREET NAME	ROAD RESERVE	BACK OF KERB OFFSET	SEWER MAIN	GAS MAIN	NON-DRINKING WATER	DRINKING WATER	TELECOM.	ELECTRICAL	ELECTRICAL POLES
BURSA DRIVE	21.50	4.05 E, 9.85 W	1.00 E	7.15 W	7.67 W	8.32 W	1.85 E	2.45 E	1.00m FROM BOK
GRIMA CRESCENT (NORTH/SOUTH)	16.00	4.05 E, 4.35 W	1.00 W	2.25 W	2.70 W	3.15 W	1.85 E	2.45 E	1.00m FROM BOK
GRIMA CRESCENT (EASTWEST)	16.00	4.05 S, 4.35 N	1.00 N	2.25 N	2.70 N	3.15 N	1.85 S	2.45 S	1.00m FROM BOK
GRIMA CRESCENT (EXTENDED DRIVEWAY)	10.00	-	1.00 N	1.90 N	2.35 N	2.80 N	-	-	-
HARP AVENUE	16.00	4.05 S, 4.35 N	-	2.25 N	2.70 N	3.15 N	1.85 S	2.45 S	1.00m FROM BOK

- NOTES**
- FOR DETAILS OF ELECTRICITY SUPPLY RETICULATION AND TELECOMMUNICATION SERVICES LAYOUTS REFER TO AUTHORITY APPROVED DRAWINGS. FOR DETAILS OF SEWER AND WATER RETICULATIONS REFER TO CARDNO DRAWINGS.
 - ELECTRICITY CONDUITS AND PITS TO BE INSTALLED IN ACCORDANCE WITH ELECTRICAL RETICULATION DRAWINGS. LOCATIONS OF ALL CONDUITS SHALL BE MARKED ON THE KERB.
 - REFER TO TELECOMMUNICATION DRAWINGS FOR DETAILS OF CONDUIT LOCATIONS. TELECOMMUNICATION CONDUITS SHALL EXTEND 1.00m INTO ALLOTMENTS. SERVICE PITS TO BE PROVIDED UNDER FOOTPATH.
 - SERVICES SHALL DEVIATE AROUND DRAINAGE PITS AND SEWER MANHOLES WHERE NECESSARY.
 - CIVIL CONTRACTOR TO CONFIRM ELECTRICAL AND TELECOMMUNICATION TRENCH WIDTHS WITH SITE SUPERINTENDENT PRIOR TO CONSTRUCTION.

Rev.	Date	Description	Des.	Verif.	Appd.
D	20/01/2017	LOT 227 HOUSE DRAIN AND LOT 243 WATER CONDUIT AMENDED	V.N.	S.W.	S.W.
C	02/11/2016	FITZROY BOX NOTE ADDED	V.N.	S.W.	S.W.
B	06/10/2016	GW CONDUIT LOCATION FOR LOT 220 & 238 & LOT 202 CROSSOVER UPDATED	V.N.	S.W.	S.W.
A	17/06/2016	CONSTRUCTION ISSUE	M.S.	S.W.	S.W.



© Cardno Limited All Rights Reserved.
This document is produced by Cardno Limited solely for the benefit of and use by the client in accordance with the terms of the retainer. Cardno Limited does not and shall not assume any responsibility or liability whatsoever to any third party arising out of any use or reliance by third party on the content of this document.

Cardno Victoria Pty Ltd | ABN 47 106 610 913
Level 4, 501 Swanston Street
Melbourne VIC 3000
Tel: 03 8415 7777 Fax: 03 8415 7788
Web: www.cardno.com.au

Drawn	Date
P.C.	14.10.2015
Checked	Date
T.C.W.	13.10.2015
Designed	Date
M.S.	06.10.2015
Verified	Date
S.W.	17/06/2016
Approved	Date
S. WARNER	02/11/2016

Client WYNNDHAM VALE PROJECTS PTY. LTD.
Project WYNNDHAM ESTATE - STAGE 2
BALLAN ROAD, WYNNDHAM VALE
WYNNDHAM CITY COUNCIL
Title CIVIL SITEWORKS SERVICES PLAN

FOR CONSTRUCTION			
Date	Melways Ref	Scale	Size
AHD	233 H11	1:500	A1
Drawing Number	Revision		
CG150059-CI-1100	D		